



FEATURE

The SMK2522CAI is an OCXO Stratum 3E fully compliant.
 Frequencies available are from 10MHz to 40MHz,
 and power supply options are 3.3V, 5V & 12V.
 These 25 x 22 mm package series of oscillators are designed
 with direct heating on a single board.

APPLICATION

- SyncE modules
- Stratum 3E timing modules
- Time and frequency references
- Test equipment



Specification for electrical appliances

Parameter	5.0V		3.3V		Unit
	MIN	MAX	MIN	MAX	
Supply Voltage(VDD) 5%	4.75	5.25	3.135	3.465	V
Frequency Range	10	40	10	40	MHz
Standard Frequency	10, 12.8, 13, 20, 24.576, 26, 40				
Frequency Tolerance*	±5-±10		±5-±10		ppb
Vs Load (±10%) change	±10		±10		ppb
Vs Aging	±10		±10		
Power consumption	3.5		3.5		W
	1.5		1.5		W
Output voltage level high (VOH)	2.4		2.4		V
Output voltage level low (VOL)	0.4		0.4		
Rise & fall time	5		5		ns
Vc Input Impedance	100		100		KΩ
Start Time	2		2		mSec
Operating temperature range	-40	80	-40	80	° C
10.00Mhz ocxo ssp phase noise					Unit
Phase Noise					dBc/Hz
10Hz			-125		
100Hz			-144		
1KHz			-155		
10KHz			-155		

EMAIL: EVA@CIMAKE.COM.CN MARK@CIMAKE.CO.UK
 TEL: +44 0208 492 6388 FAX: +44 0208 492 0196
 COMPANY ADDRESS: 419, HARBOME ROAD , EDGBASTON, BIRMING. B15 3LB



Environmental Parameters

Storage Temperature Range: -55 to 90° C

Frequency stability over temperature in still air

Shock: IEC 60068-2-27, Test Ea: 1500G acceleration for 6ms, 3 shocks in each of 3 mutually perpendicular planes

Vibration: IEC 60068-2-6, Test Fc, Procedure B4: 10Hz-60Hz, 1.5mm displacement, 60-2000Hz at 98.1m/s², 30mins in 3 mutually perpendicular planes at 1 oct/min

Solderability: MIL-STD-202, Method 208, Category 3

DIMENSION (mm)

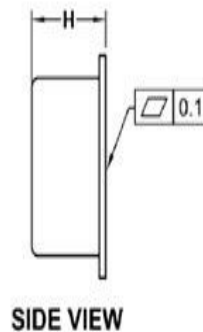
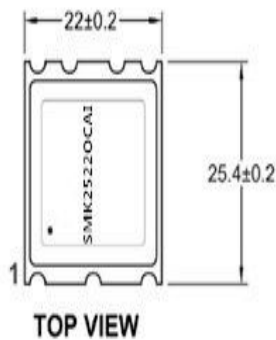

RECOMMENDED PAD LAYOUT

- TOP VIEW

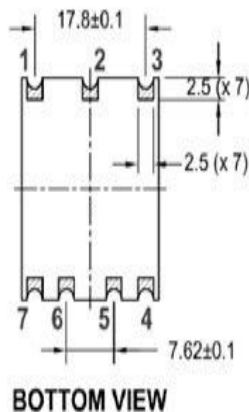
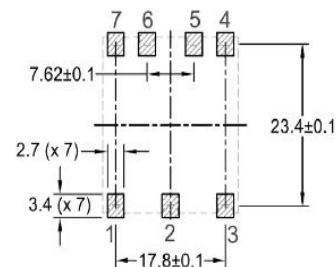

PIN CONNECTIONS

- 1 Do Not Connect
- 2 Do Not Connect
- 3 Vcc (Supply Voltage)
- 4 Output (RF Output Signal)
- 5 Do Not Connect
- 6 Do Not Connect
- 7 GND

HEIGHT (H) OPTIONS:

- H = 11.5 mm, or
- H = 15.2 mm

NOTE:

Outline unit is mm.
Tolerance is ± 0.2mm if it has not been indicated.

EMAIL: EVA@CIMAKE.COM.CN MARK@CIMAKE.CO.UK

TEL: +44 0208 492 6388 FAX: +44 0208 492 0196

COMPANY ADDRESS: 419, HARBOME ROAD , EDGBASTON, BIRMING. B15 3LB